



USB 2.0 Internal Card Reader (Multi-Slot)

User's Guide

INDEX

- ★ ***Introduction***
- ★ ***Installation Guide***
- ★ ***Troubleshooting***
- ★ ***Specifications***

Features

Thank you for purchasing USB 2.0 Card Reader. The USB 2.0 Card Reader is the most powerful and multi-functional device among all the other available readers, for it is able to access most of the storage cards and read/write 4 kinds of card at the same time.

USB 2.0 Card Reader utilizes the latest and the most useful USB 2.0 interface; and no driver needed under Windows ME/XP and Linux; bringing you convenient and high-speed access to a variety of storage cards.

USB 2.0 Card Reader supports almost all of the available storage cards including: 3.3V SmartMedia Card, Type I/II CompactFlash Card, IBM Microdrive, Memory Stick, SecureDigital Card, and MultiMedia Card.

Primary features of the USB 2.0 Card Reader include:

- * USB 2.0/1.1 interface; access speed reaches 480 Mb/s.
- * USB bus powered. AC power adapter is not required.
- * Supports Hot-Swapping and Mass Storage Class Drive; no additional driver needed under Windows ME/XP and Linux (requires editing kernel code).
- * With POWER and ACCESS LED indicators.
- * Different sockets can be used at the same time.
- * Supports for storage cards including:
 - SM Socket: 3.3V SmartMedia Card
 - SD Socket: SecureDigitalCard/MultiMedia Card
 - MS Socket: Memory Stick
 - CF Socket: Type I&II CompactFlash Card/Microdrive
- * Supports for operating systems including:
 - Windows 98/98SE/ME/2000/XP
 - Linux(kernel code 2.4.0 or later versions)

Package Contents

In the package of USB 2.0 Card Reader you will find following items. Please contact your local dealer if there are any shortages.

- * **USB 2.0 Card Reader** **X 1**
- * **Setup Disc** **X 1**
- * **Internal USB Cable** **X 1**

System Requirements

Hardware

- * IBM PC compatible computer with USB support
- * Free 3.5" drive bay
- * Windows 98/98SE/2000 requires device which can read CD-ROM

Software

- * Microsoft Windows 98/98SE/ME/2000/XP
- * Linux(kernel code 2.4.0 or later versions)

Sockets

Refer to following figure and identify the storage card your USB 2.0 Card Reader supports.

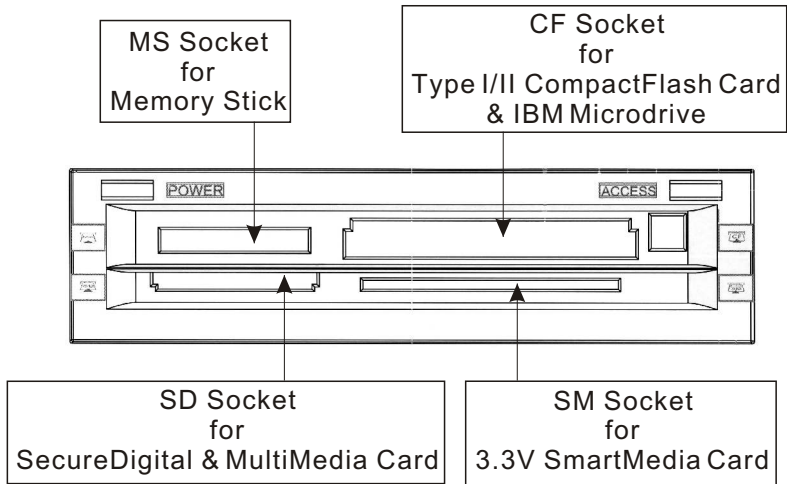

Indicators

Two active LED indicators are used to display operation status of your USB 2.0 Card Reader.

Green - Power Indicator

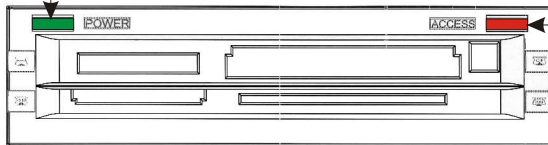

Red - Access Indicator

WARNING!

Do not insert or extract storage cards while the Red LED is flashing.

Attention!

- * On Windows 98/98SE/2000, software setup must be done first, then hardware setup.
- * Windows ME/XP requires no software setup; just connect the reader to you computer then the system will detect the new device.
- * The upper case of the computer must be remove before hardware setup. Please refer to the manual of your computer for the instruction.
- * Please be sure to remove the power plug of your computer before removing the upper case and doing hardware setup to avoid damage to the system.

Software Setup

* You can skip this chapter if your OS is Windows ME/XP.

Before connecting the USB 2.0 Card Reader into USB port, refer to following instructions to install the device driver.

1. Insert **Setup Disc** into the CD-ROM drive.
2. Double-click the CD-ROM icon in **My Computer** to browse the contents in the Setup Disc. Then, double-click the **Setup** icon.
3. Follow the on-screen instructions to complete the software setup.
4. At last, **restart the system**.

The software driver revision number is recorded in **README.TXT** in the Setup Disc. After completing device driver setup, refer to **Hardware Setup** and install the USB 2.0 Card Reader.

Hardware Setup

After completing device driver setup for your USB Card Reader and restarting the system, refer to following instructions to install the USB 2.0 Card Reader.

1. Shut down the computer and remove the power plug.
2. Remove the upper case of your computer and free a 3.5" drive bay.
3. Lift the upper case of the reader, and connect the USB cable to the connector on the PCB of the reader.

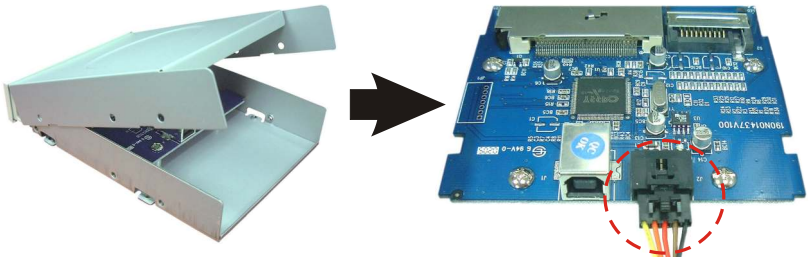

4. Re-place the upper case of the reader. Put the reader and the cable into the 3.5" drive bay, then secure the unit with screws.

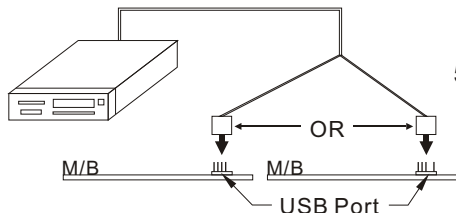
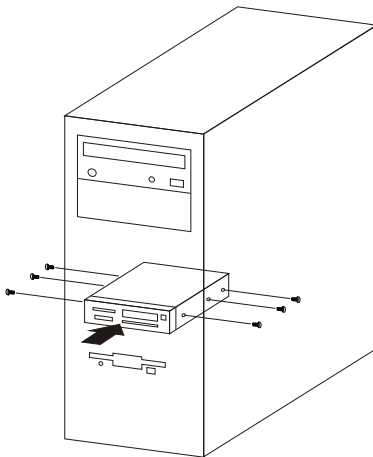

5. Connect the USB cable to the internal USB connector on the motherboard.

- * Due to certain motherboard USB headers have different pin layouts, the provided internal USB cable has two receptacles with different wire assignments for connection. Refer to following figures and instructions to learn how to correctly connect the cable to your motherboard.

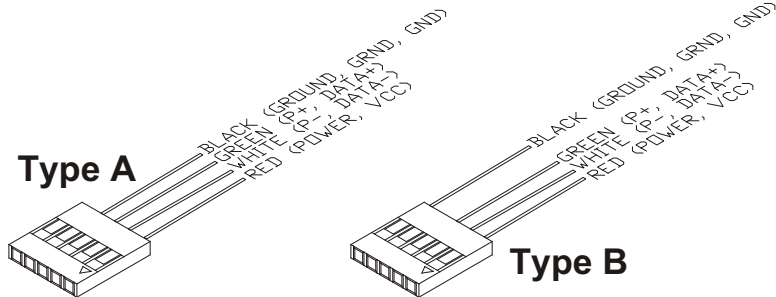

The triangle marks on both receptacles indicate the position of the socket 1 - socket of power(VCC) wire(red wire). When connecting the receptacle to PC motherboard, align the socket 1 of the receptacle with power(or VCC or +5V) pin of the USB connector on the motherboard.

About the position of power(or VCC or +5V) pin of the USB connector, please refer to the manual of the motherboard. Here we provide some most common examples of USB pin layout.

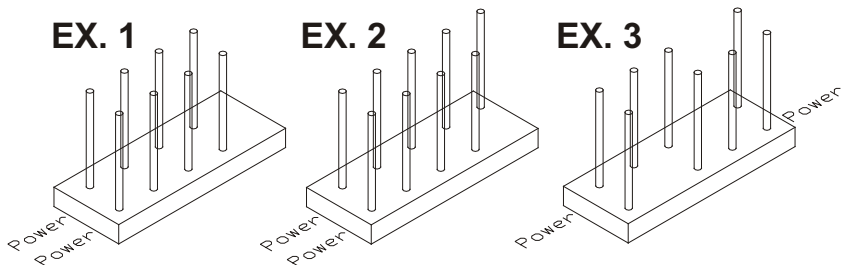

The receptacle Type A fits USB pin layout EX. 1 and EX. 2, and the receptacle Type B fits EX. 3. If the USB pin layout of your motherboard is not any one of them, just refer to the manual of your motherboard and follow the instructions above to find the receptacle you should use and the right direction.

6. Cover the upper case of the computer and plug the power back, then power on the computer.
7. While entering the system, the computer will detect and register new device.
8. Depending on the sockets the reader equipped, there should be 4 Removable Disk icons added into My Computer.
9. Installation completes.

Using the Reader

Please refer to following instructions to use the reader.

1. Insert your storage card.
2. Open **My Computer** or **File Explorer**.
3. Double-click on the proper **Removable Disk** icon.
4. Access images and files on your storage cards just as the way you open, copy, move, or delete images and files on your hard disk drive.

WARNING!

Do not insert or extract storage cards while the red LED is flashing.

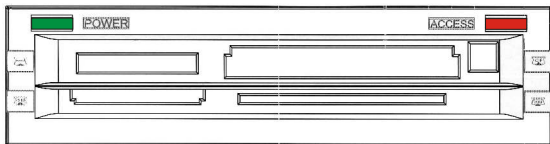

Uninstall Software

Should you feel necessary to remove the installed software and driver files of your USB 2.0 Card Reader, please refer to following instructions.

1. Unplug the reader from USB port.
2. Click **Start**, and then click **Programs**.
3. On the pop-up menu, click on **Uninstall USB Reader**.
4. A dialog box appears asking for your confirmation. Click **Yes** to continue.
5. Software and driver files of your USB 2.0 Card Reader will be removed automatically.

After removing software and driver files, you'll need to perform **Software Setup** and **Hardware Setup** before using your USB 2.0 Card Reader again.

Troubleshooting

How to use USB 2.0 Card Reader on Linux system?

The **kernel code** be should 2.4.0 or later versions. Then, the kernel code must be edited manually. Please refer to the file **LINUX_HOWTO.txt** in the Setup CD for instruction of editing source code.

Host Computer

IBM PC compatible computer with
USB 1.1/2.0 support
Windows 98/98SE/ME/2000/XP
Linux(kernel code 2.4.0 or later versions)

Sockets

3.3V SmartMedia Card socket X 1
SecureDigital / MultiMedia Card socket X 1
Memory Stick socket X 1
Type I/II CompactFlash Card socket X 1

Interface

Internal USB 2.0 device

Power

DC+5V directly from USB port

Environment

Operating temperature: 0°C~70°C
Storage temperature: -40°C~70°C
Humidity: 90% RH (max. without condensing)