

## Self-reliant with a 7" touchscreen display

A new touchscreen display integrated into the panel is the revolutionary option for the management of multimedia content and applications. Your finger replaces the input devices. Touching the display starts programs and executes commands. Shuttle D 1000H can be configured with an Intel Core 2 Duo Processor with FSB 1333 and up to 4 GB DDR2 memory. A gigabit network, USB, multi-channel audio and a PCI-Express X1 slot for an optional TV tuner card nicely finish off the offer.

## Shuttle D-Series D 1000H



Picture for illustration purposes only.

### Feature Highlight

Category	<ul style="list-style-type: none"> <li>Home-Media &amp; Basic</li> </ul>
Basis	<ul style="list-style-type: none"> <li>This is a fully configured system based on the Shuttle D-Series Barebone D10</li> <li>Chassis color: black</li> </ul>
OS	<ul style="list-style-type: none"> <li>Windows Vista (several versions)</li> </ul>
Touch-screen	<ul style="list-style-type: none"> <li>Integrated 7" Touchscreen Display</li> <li>Resolution: 800 x 480 pixel</li> </ul>
Processor	<ul style="list-style-type: none"> <li>Intel Processor with Socket 775 max. 1333MHz FSB frequency</li> <li>Core 2 Duo or Celeron</li> </ul>
Memory	<ul style="list-style-type: none"> <li>Up to. 4 GB DDR2-667/800, Dual Channel</li> </ul>
Graphics	<ul style="list-style-type: none"> <li>Integrated Intel GMA 3100 graphics</li> <li>Shared memory max. 384MB</li> <li>Supports Dual Display with internal display and external VGA display</li> </ul>
Optional TV Tuner	<ul style="list-style-type: none"> <li>Optional Hybrid TV tuner card</li> <li>Optional Media-Center remote control</li> </ul>
Audio	<ul style="list-style-type: none"> <li>Integrated 6-ch Audio</li> </ul>
LAN	<ul style="list-style-type: none"> <li>Gigabit Ethernet LAN, optional Wireless LAN</li> </ul>
Drives	<ul style="list-style-type: none"> <li>Serial-ATA hard disk</li> <li>DVD writer (Dual Format, Dual Layer)</li> </ul>
Warranty	<ul style="list-style-type: none"> <li>24 months Pick-up and Return Service</li> </ul>
Further configuration options	<ul style="list-style-type: none"> <li>It is possible to modify certain components of this system. Please refer to the "Shuttle Systems Configurator" on Shuttle's website <a href="http://sys.eu.shuttle.com">sys.eu.shuttle.com</a></li> </ul>

©2008 by Shuttle Computer Handels GmbH (Germany). All information subject to change without notice. Pictures for illustration purposes only.

## Shuttle D-Series D 1000H Specifications (configurable)

<i>Range of application</i>	Recommended range of application: Home-Media & Basic
<i>Basis</i>	System based on: Shuttle Barebone D10
<i>Operating system</i>	Microsoft Windows Vista (various versions available) 9 languages available: German, English, French, Dutch, Italian, Spanish, Swedish, Finnish, Danish
<i>Chassis</i>	G7-type aluminum chassis, black color Storage bays: 2x 3.5" internal, 1 x 5.25" external Dimensions: 30.5 x 20 x 18.5 cm (LWH) = 11.3 litres
<i>7" Display</i>	Integrated 7" Display Active area: 152.4 x 91.44 mm (7 inch) Resolution: 800x480 pixels Color depth: 262144 (18 bits) Backlight unit: High power LED OSD (On Screen Display): 3 Buttons
<i>Touchscreen</i>	Touchscreen function support fingertip input Electric capacity solution
<i>Optional Remote Control</i>	Optional: Media Center Infrared Remote Control
<i>Processor</i>	Intel Processor with Socket 775 Celeron or Core 2 Duo with up to 1333MHz FSB
<i>Processor cooling</i>	Shuttle I.C.E. (Integrated Cooling Engine) Advanced I.C.E. Heatpipe technology, linear controlled 92mm fan SilentX cooling and noise reduction technology with Active Airflow
<i>Chipset</i>	Intel G31 Express (Bearlake-G) + ICH7
<i>Hard disk</i>	3.5" Serial ATA II hard disk with up to 1000GB capacity
<i>Optical drive</i>	5.25" DVD writer supports dual layer, dual format
<i>Memory</i>	With up to 4GB DDR2-667/800 SDRAM memory Supports dual channel

<p><i>Integrated Graphics</i></p>	<p>Intel Graphics Media Accelerator 3100 (GMA 3100)                  256bit 3D engine with a powerful 400MHz core                  DirectX 9.0 support                  Dynamic Video Memory Technology (DVMT) 3.0                  Shared Memory size up to 384MB                  Dual View - two displays can be used at the same time:                  Analog D-Sub VGA and integrated 7" display.                  Analog D-Sub Output: max. 2048x1536 pixels with 32-bit color at 75 Hz</p>
<p><i>Optional TV card</i></p>	<p>With optional Hybrid TV tuner card                  Supports analog cable with FM tuner or DVB-T                  PCI-Express x1 slot interface</p>
<p><i>Audio</i></p>	<p>Audio Realtek® ALC 662 6-channel High-Definition Audio                  Three analog audio connectors (3.5mm) at the Back-Panel:                  1) Front Line out (head phone)                  2) Rear Surround line-out (shared with microphone input)                  3) Center line-out (shared with Line in)</p>
<p><i>LAN</i></p>	<p>Gigabit LAN Controller                  Marvell 88E8056 Ethernet network controller (Gigabit)                  Supports 100 / 1.000 MBit/s operation                  Supports Wake-on-LAN (WOL)</p>
<p><i>Opt. WLAN</i></p>	<p>Optional Shuttle Wireless LAN module PN20                  Supports WiFi IEEE 802.11b/g with up to 54 Mbps data rate                  Wi-Fi Protected Access: WEP, WPA, WPA2                  External Antenna, designed for Shuttle XPC                  Internal USB connector</p>
<p><i>Front-panel</i></p>	<p>Power button                  Power LED                  HDD LED                  7" Touchscreen Display                  3 buttons for On-Screen-Display settings (for 7" display)</p>
<p><i>Back-panel I/O connectors</i></p>	<p>VGA output (D-sub, analog)                  4x USB 2.0                  GigaBit LAN (RJ45)                  PS/2 keyboard                  PS/2 mouse                  Audio Line-in                  Audio Line-out                  Audio Mic-in                  Serial port (RS232)                  Perforation for optional Parallel port (LPT)</p>

©2008 by Shuttle Computer Handels GmbH (Germany). All information subject to change without notice. Pictures for illustration purposes only.

<p><i>Power supply</i></p>	<p>100 Watt Flex ATX power supply unit PC36                  Input voltage range: 100~240V AC, 47~63 Hz                  Active PFC (Power Factor Correction)                  EMI Certified: FCC, CE, BSMI, C-tick                  Safety Certified: UL, TÜV, CB, BSMI                  ATX power connectors: 2x10 pin and 2x2 pins (for 12V)                  Power plug region specific                  40 mm cooling fan sensor control</p>
<p><i>Further configuration options</i></p>	<p>It is possible to modify certain components of this system.                  Please refer to the "Shuttle Systems Configurator".                  URL: <a href="http://sys.eu.shuttle.com">sys.eu.shuttle.com</a></p>
<p><i>Warranty</i></p>	<p>24 Months Pick-Up-And-Return Service</p>

## Connectors

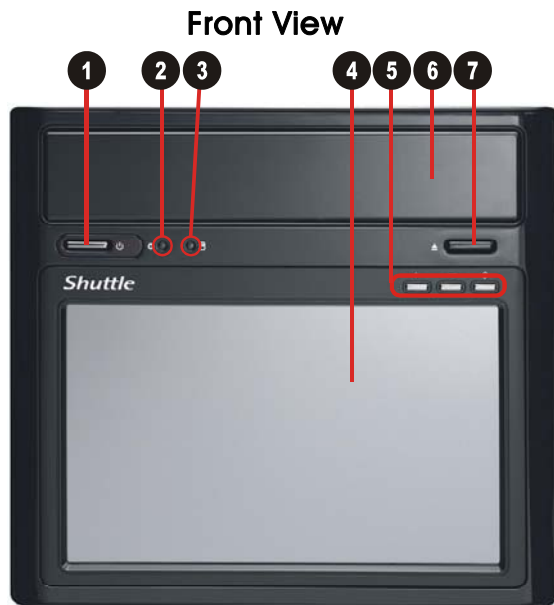

### Front View

- 1 Power button
- 2 Power LED
- 3 Hard disk LED
- 4 7" Touchscreen
- 5 3 On-Screen-Display buttons
- 6 5.25" bay for optical drive
- 7 Eject button for optical drive

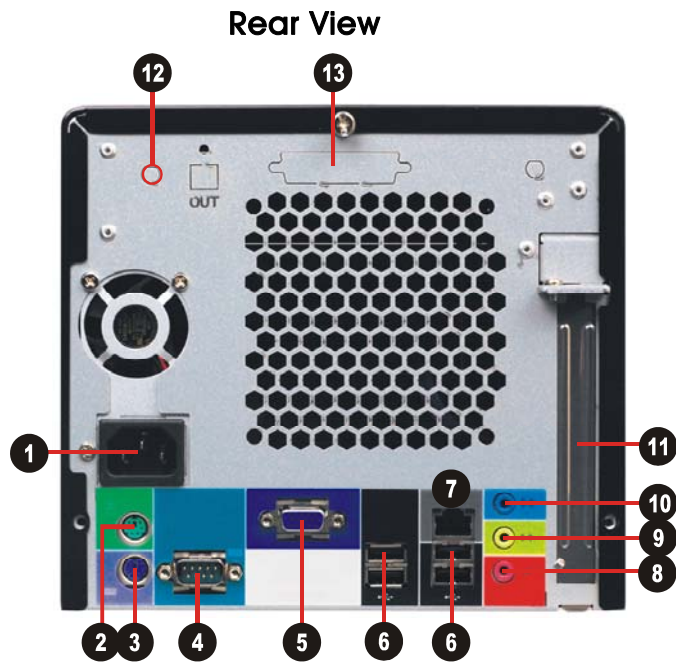

### Rear View

- 1 AC Power Plug
- 2 PS/2 mouse connector
- 3 PS/2 keyboard connector
- 4 Serial port
- 5 Sub-D VGA connector
- 6 4x USB 2.0 ports
- 7 Gigabit LAN port
- 8 Microphone input
- 9 Audio Line output
- 10 Audio Line input
- 11 PCI Express x1 slot
- 12 Optional WLAN (PN20)
- 13 Optional parallel port (PC8)

©2008 by Shuttle Computer Handels GmbH (Germany). All information subject to change without notice. Pictures for illustration purposes only.